



# GAOTH NA MARA

## SPECIFICATION SHEET

**VESSEL NAME:**  
GAOTH NA MARA  
IMO 9679737

### VESSEL DIMENSIONS

LOA	26.30 m.
Load Length	23.98 m.
Beam	10.20 m.
Draft	2.20 m.
Tonnage	Gross 81.58 (UK)
	Net 81.58 (UK)

### General

Builder Damen Shipyards

Built 2012

Classification Bureau Veritas

Notation 1A1 HSLC R1 Windfarm Service 1

Hull material Aluminium

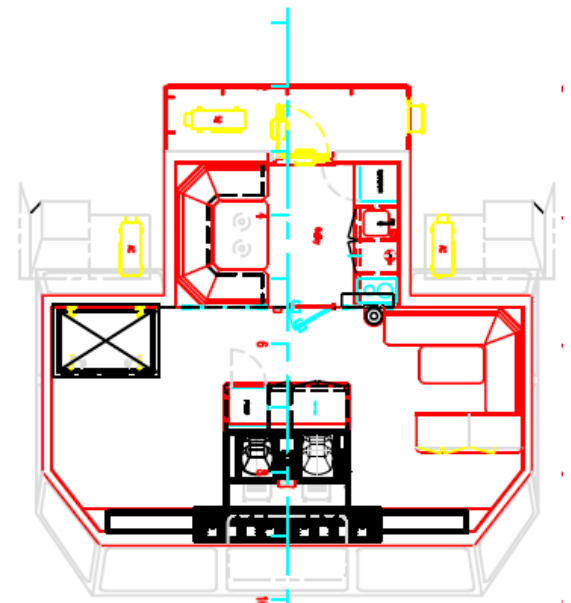
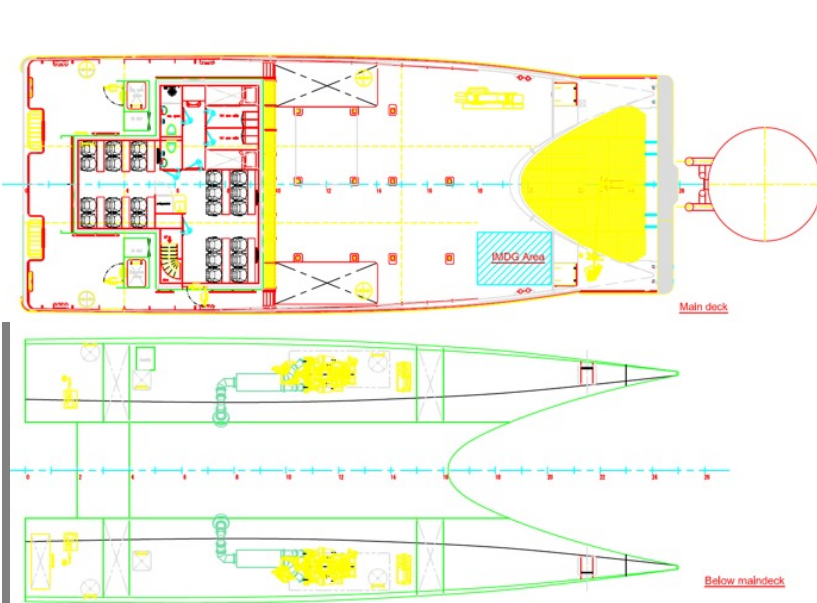

## TECHNICAL DATA SPECIFICATION

PERFORMANCE	
Speed	22 kts service speed

25 kts. Sprint

Consumption eco	300 l/hr at 18-20kts
-----------------	----------------------

Consumption max 425l/hr at 25kts

CAPACITIES	
Pax capacity	24 pax motion dampened seats

Deadweight Up to 20 tonnes

Cargo	15 tonnes
-------	-----------

Loading area 90 m2 fwd deckspace

Deck load	1.5 tonnes / m2
-----------	-----------------

TANK CAPACITIES	
Fuel Oil	22 m <sup>3</sup>

Fresh water 1.7 m3

COMMUNICATION	
Searchlight	Pesch 1000W 230V

VHF Sailor RT 6222 DSC

Inmarsat-C	Sailor TT 3000 E
------------	------------------

AIS JRC JHS 182

DECK EQUIPMENT	
Deck crane	Heila 20/5S+1PM, capacity 2.75 tonnes @ 8.60 m.

Fenders RG Seaside heavy-duty bow fender

Fuel hose reel	Below-deck
----------------	------------

Container fittings 2x 20 ft

MACHINERY	
Main engines	2x Caterpillar C32 TTA

Output 2,400 hp total

Gearboxes	Reinitjes ZWVS440/1 (two speed)
-----------	---------------------------------

Generators 2x Caterpillar C2.2

Output	2x 22.5 kW / 28 kVA
--------	---------------------

Propulsion 2x FPP in kort nozzles

Rudders	2x
---------	----

Bow thruster 2x hydraulic bow thrusters, 50 kW

NAVIGATION EQUIPMENT	
Radar	JRC JMA 5212-4 MK2

GPS navigation JRC JRL-20

ECDIS	Furuno RT 6222 DSC
-------	--------------------

Echo sounder JRC JFE-380

Navtex	JRC NCR 333
--------	-------------

Magn. Compass Alphantron MFD

Auto pilot	JRC NT 888GSpeed 1500
------------	-----------------------

Anemometer Maretron

SAR finder	Sea Marshal
------------	-------------

CCTV 8x camera deck system, 1x night vision camera

ACCOMMODATION	
Cabins	2 (can be increased to 4)

Total berths 4

Amenities	Galley, toilets and showers on main deck. Kitchenette, settee and desk on bridge. All spaces heated and air-conditioned.
-----------	--

**Address:** Intermara Marine LTD

3 Seagate,  
Peterhead  
AB42 1JP

**Phone:** +44 1779 418148

**Mobile:** +44 7738931075

**E-mail:** Stewart@Intermara.co.uk

www.intermara.co.uk



**Intermara**  
MARINE